

DEMOLITION LEGEND:



TREE TO BE REMOVED

REV.	DATE	DESCRIPTION	APP'D BY

ALDI - PERISHABLE WAREHOUSE
HAINES CITY

HAINES CITY GATEWAY SIGN EXHIBIT



**HIGHLAND
ENGINEERING, INC.**
1172 S. Grand Highway
Dermott, Florida 34711
Office 407-275-7877
Fax 407-275-7801
CA No. 27612

JOB No.:	ALD-001.15
DESIGNED BY:	JB
DRAWN BY:	BM/JK
APPROVED BY:	JB
DATE:	8-5-2024
SHEET:	EXHIBIT 1

NOT FOR CONSTRUCTION
UNLESS SIGNED AND SEALED

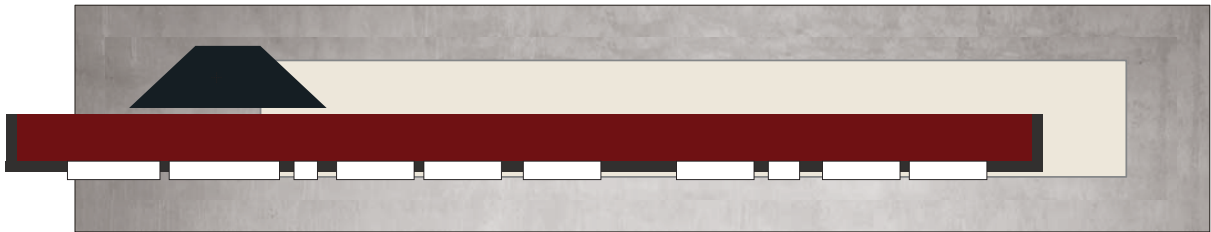

AECOM

150 N. ORANGE AVENUE SUITE 200
ORLANDO, FL 32801

- These drawings are intended to illustrate design intent only and are not for construction. All final engineering and conditions of the project are the responsibility of the fabricator. Shop drawings by the fabricator must be submitted for approval, prior to proceeding with fabrication.
- The quality of fit and finish on the final product must meet or exceed the requirements of these design intent documents. Any variations to design, materials, or fabrication methods must be approved by the Owner.
- Colors shown are for reference only and are subject to the limitations of the printing process. Refer to referenced color systems contained within these drawings for actual specifications.
- Scaled examples shown are for reference only, and do not necessarily reflect actual site conditions. Detailed site surveys are required prior to fabrication and installation.
- All locations shown are approximate. All final locations are to be determined during pre-installation and site walk-thru prior to sign fabrication and must be approved by Owner.

CLIENT

Haines City

PROJECT

Haines City Gateway Signage

ISSUE DATE

June 5, 2024

SHEET TITLE

Main ID Sign - Concept A

SHEET NUMBER

AG201

- These drawings are intended to illustrate design intent only and are not for construction. All final engineering and conditions of the project are the responsibility of the fabricator. Shop drawings by the fabricator must be submitted for approval, prior to proceeding with fabrication.
- The quality of fit and finish on the final product must meet or exceed the requirements of these design intent documents. Any variations to design, materials, or fabrication methods must be approved by the Owner.
- Colors shown are for reference only and are subject to the limitations of the printing process. Refer to referenced color systems contained within these drawings for actual specifications.
- Scaled examples shown are for reference only, and do not necessarily reflect actual site conditions. Detailed site surveys are required prior to fabrication and installation.
- All locations shown are approximate. All final locations are to be determined during pre-installation and site walk-thru prior to sign fabrication and must be approved by Owner.

CLIENT

Haines City

PROJECT

Haines City Gateway Signage

ISSUE DATE

June 5, 2024

SHEET TITLE

Main Identification Sign
Detail Enlargement

SHEET NUMBER

AG205

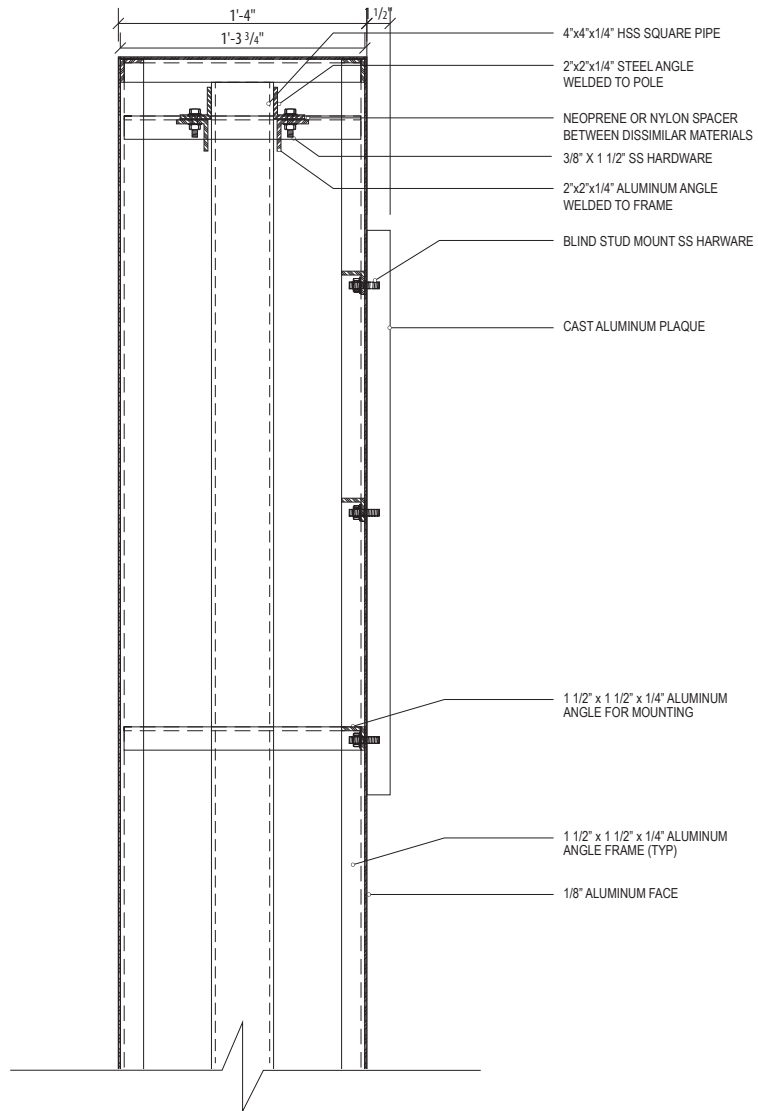

DETAIL ENLARGEMENT

1 1/2" = 1' 0"

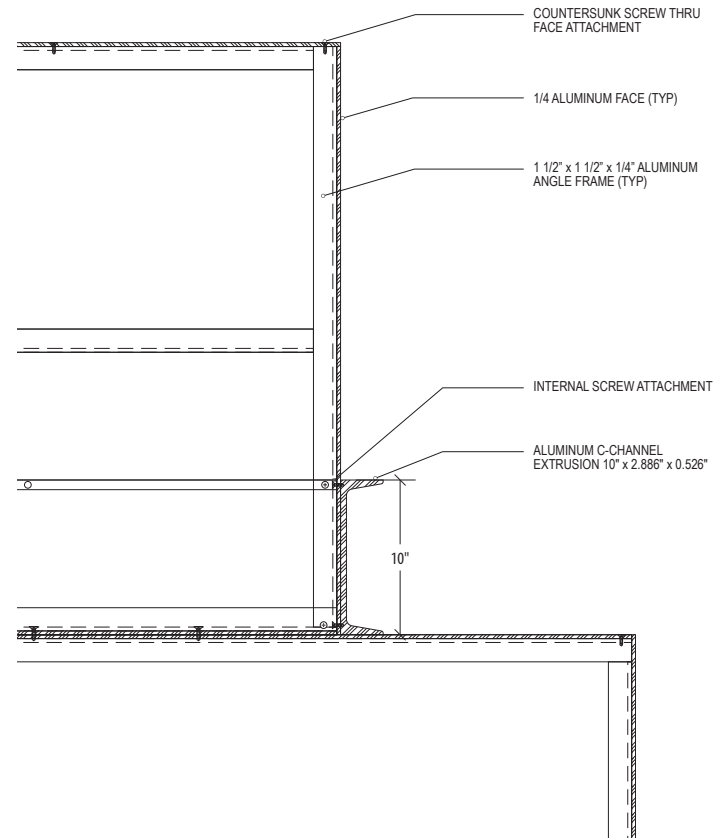

DETAIL ENLARGEMENT

1 1/2" = 1' 0"